

EXISTING	PROPOSED
PROPERTY LINE	PROPERTY LINE
CONCRETE CURB	CONCRETE CURB
CONC. SIDEWALK	CONC. SIDEWALK
BUILDING	BUILDING
RETAINING WALL	RETAINING WALL
DOOR LOCATION	DOOR LOCATION
OVERHEAD DOOR LOCATION	OVERHEAD DOOR LOCATION
STOP BAR WITH STOP SIGN	STOP BAR WITH STOP SIGN
FENCELINE CHAINLINK	FENCELINE CHAINLINK
FENCELINE WOODEN	FENCELINE WOODEN
GUADERNAL	GUADERNAL
RIGHT OF WAY	RIGHT OF WAY
STREAM	STREAM
STREAM BUFFER	STREAM BUFFER
SIGN	SIGN
VEHICLE ACCESS PATH	VEHICLE ACCESS PATH
ASPHALT PAVING	ASPHALT PAVING
HEAVY DUTY ASPHALT PAVING	HEAVY DUTY ASPHALT PAVING
CONCRETE PAVING	CONCRETE PAVING
TREE LINE	TREE LINE

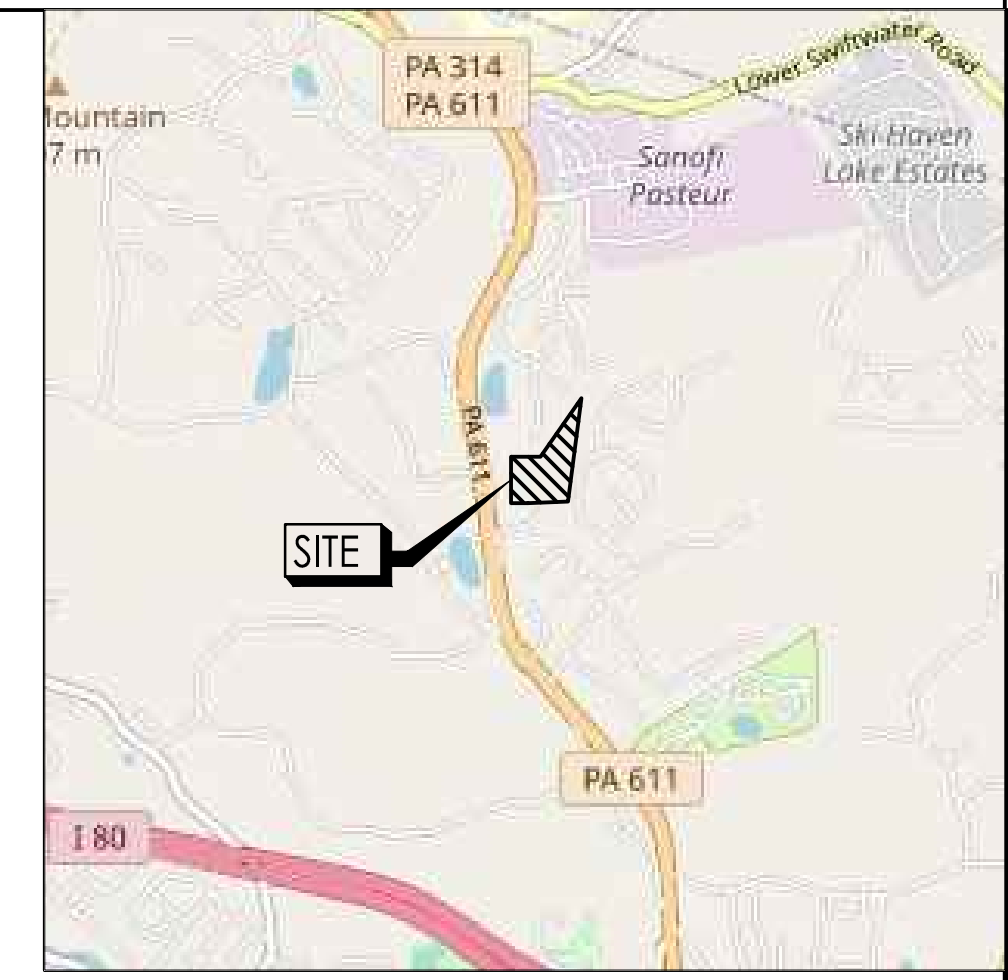

LOCATION MAP

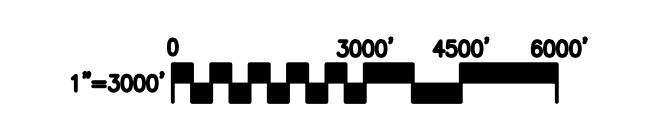

- NOTES:**
- THIS SURVEY PLAN IS THE RESULT OF A FIELD SURVEY PERFORMED BY SUSQUEHANNA CIVIL IN JUNE OF 2022.
 - BOUNDARY SHOWN ON THIS SURVEY PLAN IS FOR REFERENCE ONLY AND IS BASED ON PLATS AND PLANS PROVIDED BY SUSQUEHANNA CIVIL.
 - THIS SURVEY PLAN WAS PREPARED WITHOUT THE BENEFIT OF A TITLE REPORT AND IS SUBJECT TO THE FINDINGS A VALID TITLE REPORT WOULD DISCLOSE. NOT FOR CONSTRUCTION. FOR TITLE AND CONVEYANCE PURPOSES ONLY.
 - ATTENTION IS CALLED TO POCONO TOWNSHIP ZONING CODE AS AMENDED. PROPERTY IS ZONED COMMERCIAL (C).
 - BY GRAPHIC PLOTTING ONLY, THIS PROPERTY CONTAINS ZONE A. (DETERMINED TO BE IN A BASE FLOOD ELEVATION) OF THE FLOOD INSURANCE RATE MAP, COMMUNITY PANEL NUMBERS, 4208C0254E, WHICH BEAR AN EFFECTIVE DATE OF 05/05/2013.
 - UTILITY INFORMATION FROM SURFACE EVIDENCE OBSERVED IN THE FIELD. ALL UTILITY LOCATIONS AND DEPTHS SHALL BE FIELD VERIFIED PRIOR TO CONSTRUCTION. THE LOCATION OF UNDERGROUND UTILITIES IS TAKEN FROM PUBLIC RECORDS AND FIELD LOCATION OF VENTS, VALVES, MANHOLES, INLETS ETC. THE EXTENT, EXACT LOCATION AND DEPTH OF UNDERGROUND UTILITIES HAS NOT BEEN INDEPENDENTLY VERIFIED BY THE OWNER OR ITS REPRESENTATIVE. THE CONTRACTOR SHALL DETERMINE THE EXTENT AND EXACT LOCATION AND DEPTH OF ALL EXISTING UTILITIES PRIOR TO COMMENCING WORK. THE CONTRACTOR AGREES TO BE FULLY RESPONSIBLE FOR ANY AND ALL DAMAGES WHICH MIGHT BE OCCASIONED BY THE CONTRACTOR'S FAILURE TO EXACTLY LOCATE AND PRESERVE ANY AND ALL UNDERGROUND UTILITIES. CONTRACTOR SHALL NOTIFY UTILITY COMPANIES THREE (3) DAYS PRIOR TO COMMENCING WORK TO COMPLY WITH PA ACT No.287.
 - UTILITY INFORMATION OBTAINED BY SUBSURFACE UTILITY EXPLORATION (SUE), SURVEY BY THE LEXIS GROUP LLC, COMPLETED ON 09/09/2022. A "SITE INVESTIGATION OF UNDERGROUND UTILITIES VERIFIED UTILITY LOCATIONS" PLAN WAS PREPARED BY THE LEXIS GROUP, DATED 9/26/2023. THE CONTRACTOR SHALL VERIFY ALL UTILITY LOCATIONS AND DEPTHS PRIOR TO CONSTRUCTION AND REPORT ANY DISCREPANCIES TO THE CITY AND PROJECT PROFESSIONAL.
 - SOIL DELINEATION LINES TAKEN FROM WEB SOIL SURVEY URL: [HTTP://WEBSOILSURVEY.NRC.USDA.GOV](http://websoilsurvey.nrcs.usda.gov). COORDINATE SYSTEM: WEB MERCATOR (EPSG:3857). THIS PRODUCT IS GENERATED FROM THE USDA-NRCS CERTIFIED DATA AS OF SOIL SURVEY AREA: MONROE COUNTY, PENNSYLVANIA SURVEY AREA DATA: VERSION 16, SEPTEMBER, 2021.
 - LACKAWANNA CHANNEL: LOAM, 8 TO 25 PERCENT SLOPES, RUBBLY. MORRIS CHANNEL: SILT LOAM, 0 TO 8 PERCENT SLOPES, EXTREMELY STONY. O&B-QUAJA-LACKAWANNA COMPLEX, 0 TO 8 PERCENT SLOPES, EXTREMELY STONY. O&B-QUAJA-LACKAWANNA COMPLEX, 8 TO 25 PERCENT SLOPES, EXTREMELY STONY.
 - THE LOCATION OF ALL FEATURES AND APPURTENANCES SHOWN HEREON ARE A GRAPHIC REPRESENTATION OF THE SITE. NO COORDINATE VALUES HAVE BEEN CREATED FOR THESE FEATURES. THE USER OF THESE PLANS ASSUMES ALL RESPONSIBILITY FOR THE FEATURES AND/OR CONSTRUCTION OF THE SAME.
 - EXISTING FACILITIES ARE SERVICED BY PUBLIC SANITARY SEWER AND PUBLIC WATER.
 - A PHASE I ENVIRONMENTAL SITE ASSESSMENT WAS PREPARED BY NICLAUS ENGINEERING CORPORATION, DATED APRIL 17, 2009.

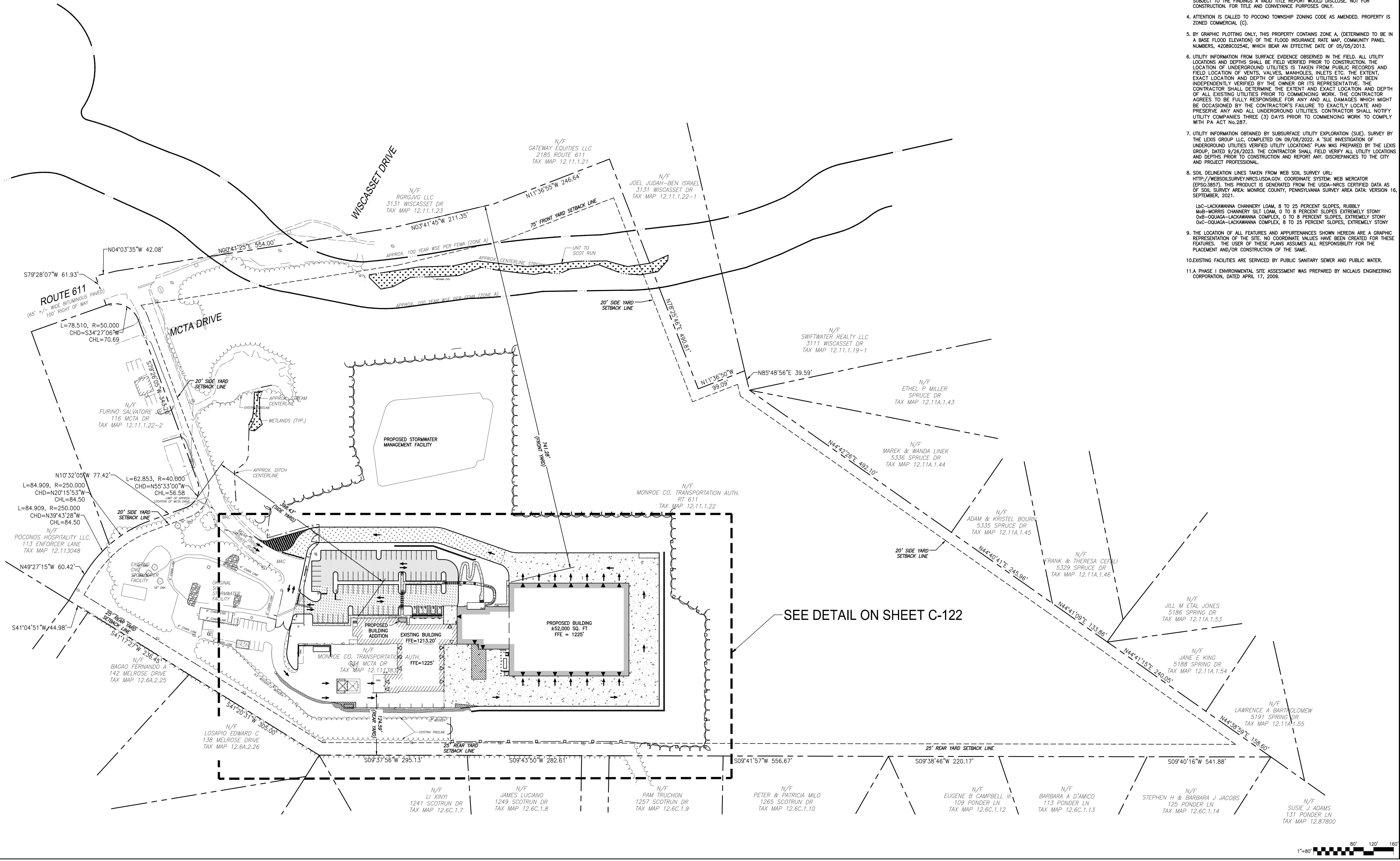

SEE DETAIL ON SHEET C-122



Stantec Consulting Services Inc.
5000 Ritter Road Suite 102
Mechanicsburg, PA 17055 • www.stantec.com

Copyright Reserved
The Contractor shall verify and be responsible for all dimensions. DO NOT scale the drawing. Any errors or omissions shall be reported to Stantec without delay. The Contractor shall be responsible for obtaining all necessary permits. Reproduction or use for any purpose other than that authorized by Stantec is forbidden.

Legend

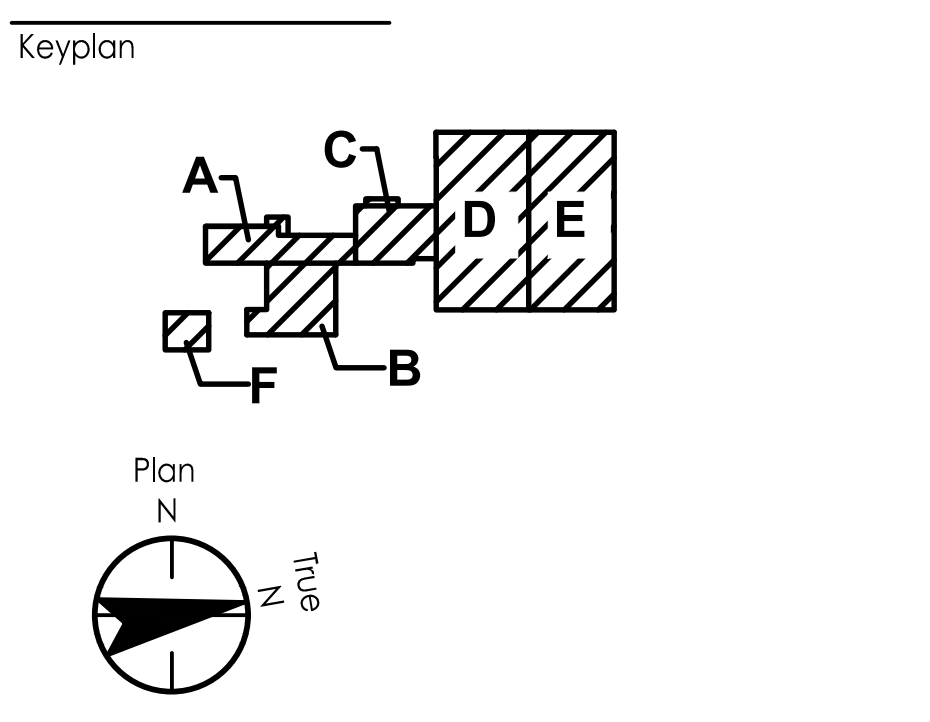

Issue/Revision	Date
60% DESIGN SUBMISSION	2023.11.30
SCHEMATIC DESIGN SUBMISSION	2022.09.30
Issue/Revision	YYYY.MM.DD

PRELIMINARY NOT FOR CONSTRUCTION
Not for permits, pricing or other official purposes. This document has not been completed or checked and is for general information or comment only.



MCTA Transit Facility

PennDOT
134 MCTA DR SWIFTWATER, PA, 18370
Title
SITE PLAN

Project No. 2027131641
Revision 0
Scale 1"=80'
Drawing No. C-121